

SALEM



# SALEM

BY FOREST RIVER



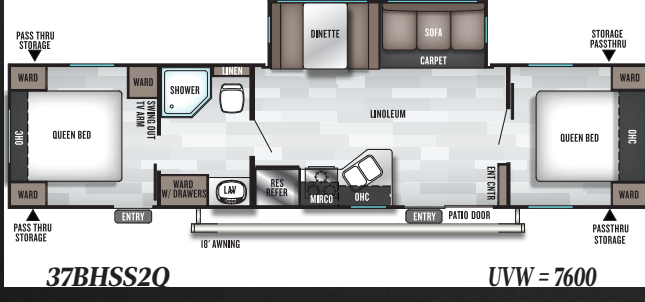
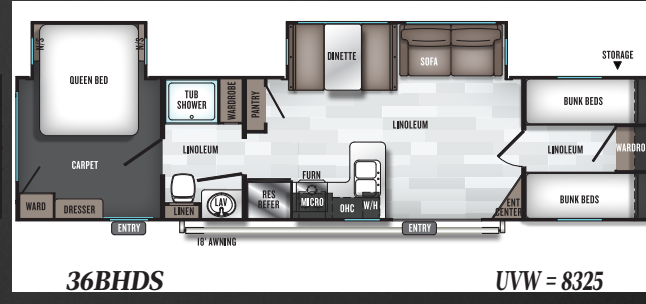
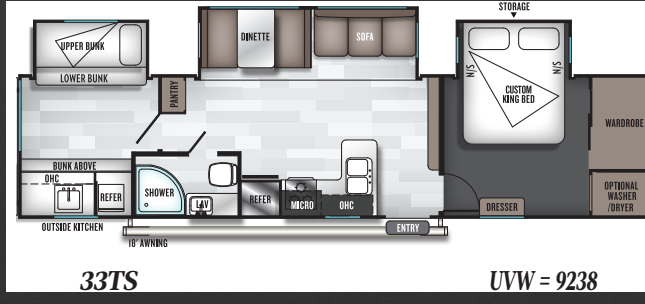
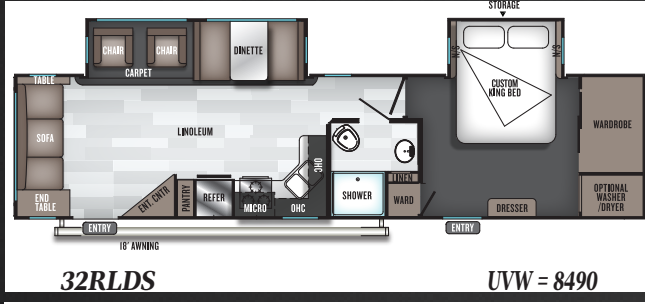
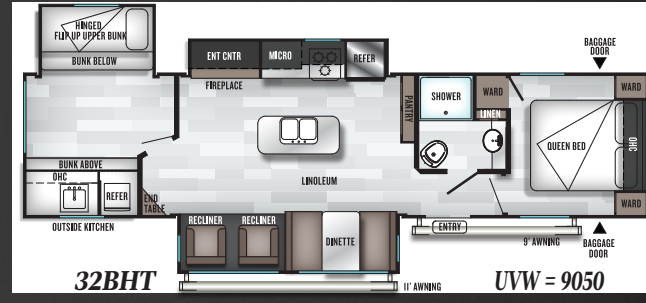
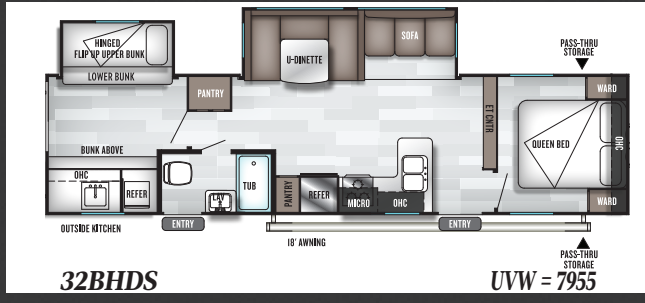
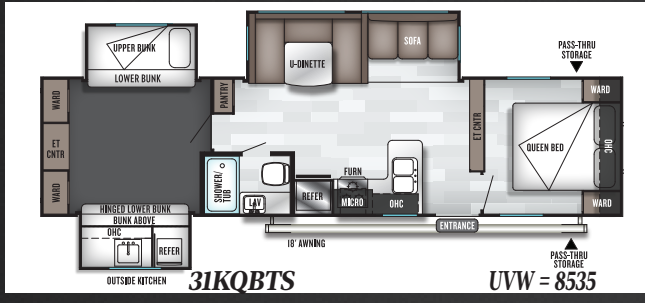
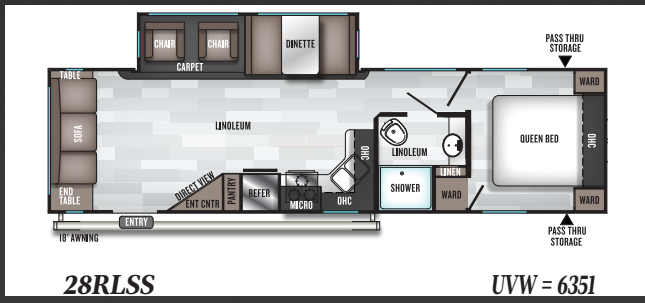
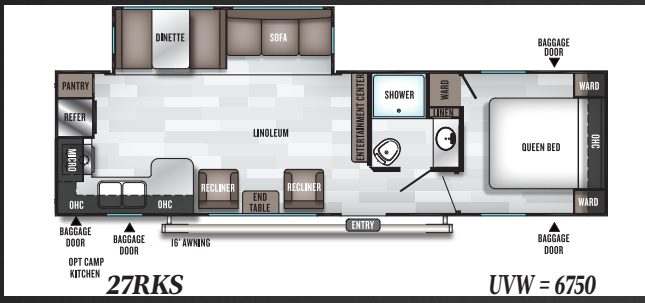
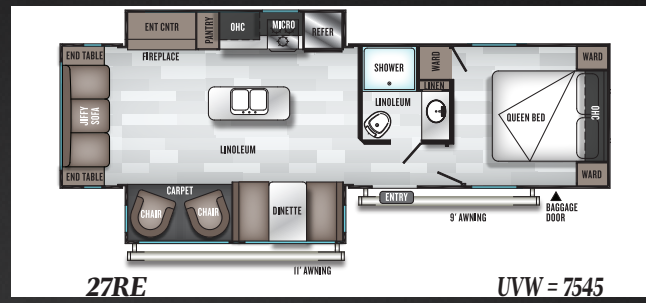
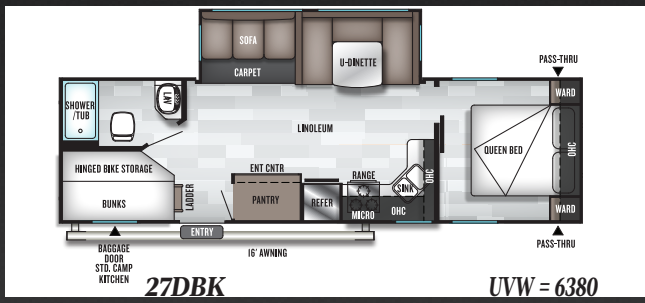
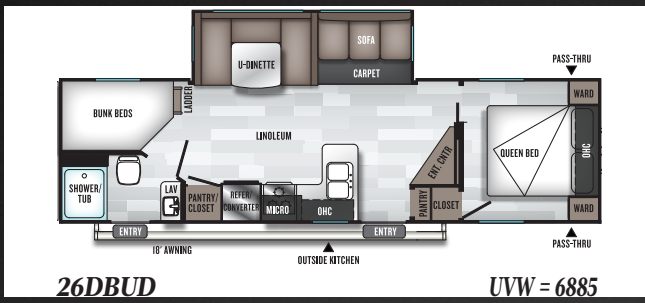

	26DBUD	27DBK	27RE	27RKS	28RLSS	30QBSS	31KQBTs	32BHDS	32BHT	32RLDS	33TS	36BHDS	37BHSS20
UVW	6885	6380	7545	6750	6351	6780	8535	7955	9050	8490	9238	8325	7600
Hitch Wt.	795	701	955	950	762	860	905	859	1080	980	1088	1015	970
Carrying Capacity	2672	1283	2332	1162	1373	2821	1292	1826	2192	1412	1852	3316	2271
Ext. Length	33'2"	32'0"	33'6"	33'7"	34'1"	33'0"	36'6"	35'8"	37'6"	38'	38'9"	38'8"	39'0"
Ext. Height	11'2"	11'4"	11'5"	11'2"	11'5"	11'2"	11'3"	11'2"	11'7"	11'2"	11'7"	11'2"	11'2"
Fresh Water	40	39	40	40	40	39	39	39	40	40	40	40	39
Gray Water	60	60	57	54	30	57	54	57	57	27	54	27	30
Black Water	30	30	38	27	30	27	27	30	38	27	30	38	27
Tire Size	15"	15"	15"	15"	15"	15"	15"	15"	15"	15"	15"	15"	15"

SALEM  
**360° TOURS**







27RE (SHOWN IN OYSTER DECOR)



26DBUD (SHOWN IN MARBLE DECOR)

# DETAILS MATTER.

WHERE AFFORDABILITY AND LUXURY COLLIDE.



SALEM



OTHER BRANDS

### Storage matters.

Our STOW AND GO storage system offering storage under dinette, couch and bed. Maximizes your storage space and makes preparation for camping a breeze.



SALEM

OTHER BRANDS

### Refrigerators matter.

Stainless Steel 10.7 cu ft that is 78% larger than competition. Offering glass rather than wire shelves. Perfect for both dry camping and when plugged in.

### Strong foundation matters.

JT-Strong Arms - Typically reserved for high-end fifth wheels, will make your trailer feel like it is sitting on a house foundation...Rock Solid Setup - Every time.



OTHER BRANDS



SALEM



SALEM



OTHER BRANDS

### Stairs matter.

Entering your coach should be safe and easy. Our triple step system is unparalleled for safety and convenience.



OTHER BRANDS

### Comfort matters.

Coleman Brand Air Conditioners are the leaders in quiet, and efficient systems. No more yelling over the noise. Enjoy comfort and quiet with Coleman.

VISIT [FORESTRIVERINC.COM/SALEM](http://FORESTRIVERINC.COM/SALEM)

TO EXPERIENCE COMPLETE STANDARDS & MUCH MORE

**SPECIFICATION DEFINITIONS**

**GVWR (Gross Vehicle Weight Rating)** - is the maximum permissible weight of the unit when fully loaded. It includes all weights, inclusive of all fluids, cargo, optional equipment and accessories. For safety and product performance do NOT exceed the GVWR.

**GAWR (Gross Axle Weight Rating)** - is the maximum permissible weight, including cargo, fluids, optional equipment and accessories that can be safely supported by a combination of all axles.

**UVW (Unloaded Vehicle Weight)\*** - is the typical weight of the unit as manufactured at the factory. It includes all weight at the unit's axle(s) and tongue or pin and LP Gas. The UVW does not include cargo, fresh potable water, additional optional equipment or dealer installed accessories.

\*Estimated average based on standard build optional equipment.

**CCC (Cargo Carrying Capacity)\*\*** - is the amount of weight available for fresh potable water, cargo, additional optional equipment and accessories. CCC is equal to GVWR minus UVW. Available CCC should accommodate fresh potable water (8.3 lbs per gallon). Before filling the fresh water tank, empty the black and gray tanks to provide for more cargo capacity.

\*\* Estimated average based on standard build optional equipment

Each Forest River RV is weighed at the manufacturing facility prior to shipping. A label identifying the unloaded vehicle weight of the actual unit and the cargo carrying capacity is applied to every Forest River RV prior to leaving our facilities.

The load capacity of your unit is designated by weight, not by volume, so you cannot necessarily use all available space when loading your unit.

# THE SALEM LINE-UP



SALEM



SALEM CRUISE LITE



SALEM VILLA | VILLA ESTATE



SALEM HEMISPHERE

**CUSTOMER SATISFACTION**



[www.ForestRiverBuyLocal.com](http://www.ForestRiverBuyLocal.com)

**FREE MEMBERSHIP**  
to Forest River Owners' Group



[www.forestrivermag.com](http://www.forestrivermag.com)



**Learn More**  
Scan this barcode using a QR Reader on your smart phone to learn more about Forest River.



A Berkshire Hathaway company.

Forest River, Inc. 55470 C.R. 1 Elkhart, IN 46515 | (574) 533-5934  
[www.forestriverinc.com/Salem](http://www.forestriverinc.com/Salem) | [www.forestriveraccessories.com](http://www.forestriveraccessories.com)



**PRE-DELIVERY INSPECTION FACILITY**

20,000 square feet of quality assurance. The bare essentials for a premium product. This state-of-the-art facility gives immediate daily feedback to production for quality assurance in every unit built.

**24/7 EMERGENCY  
ROADSIDE ASSISTANCE  
WITH VEHICLE PURCHASE\***

- |                |                 |
|----------------|-----------------|
| TOWING         | WINCH-OUT       |
| JUMP-STARTS    | MOBILE MECHANIC |
| TIRE CHANGES   | TECHNICAL       |
| FLUID DELIVERY | SUPPORT         |
| LOCKOUT        | DEALER LOCATOR  |
| SERVICE        | SERVICES        |



\*VALID FOR 1 YEAR FROM DATE OF PURCHASE

**YOUR SALEM DEALER**

2019

All information contained in this brochure is believed to be accurate at the time of publication. However, during the model year, it may be necessary to make revisions and Forest River, Inc., reserves the right to make all such changes without notice, including prices, colors, materials, equipment and specifications as well as the addition of new models and the discontinuance of models shown in this brochure. Therefore, please consult with your Forest River dealer and confirm the existence of any materials, design or specifications that are material to your purchase decision. Litho. U.S.A. FOR 1539 P/W: 2018.11.27